



MODEL: DG

OPERATING INSTRUCTION AND PARTS MANUAL

■ DG-3022

■ DG-3025

■ DG-3030

■ DG-3530

■ DG-3535

■ DG-4040

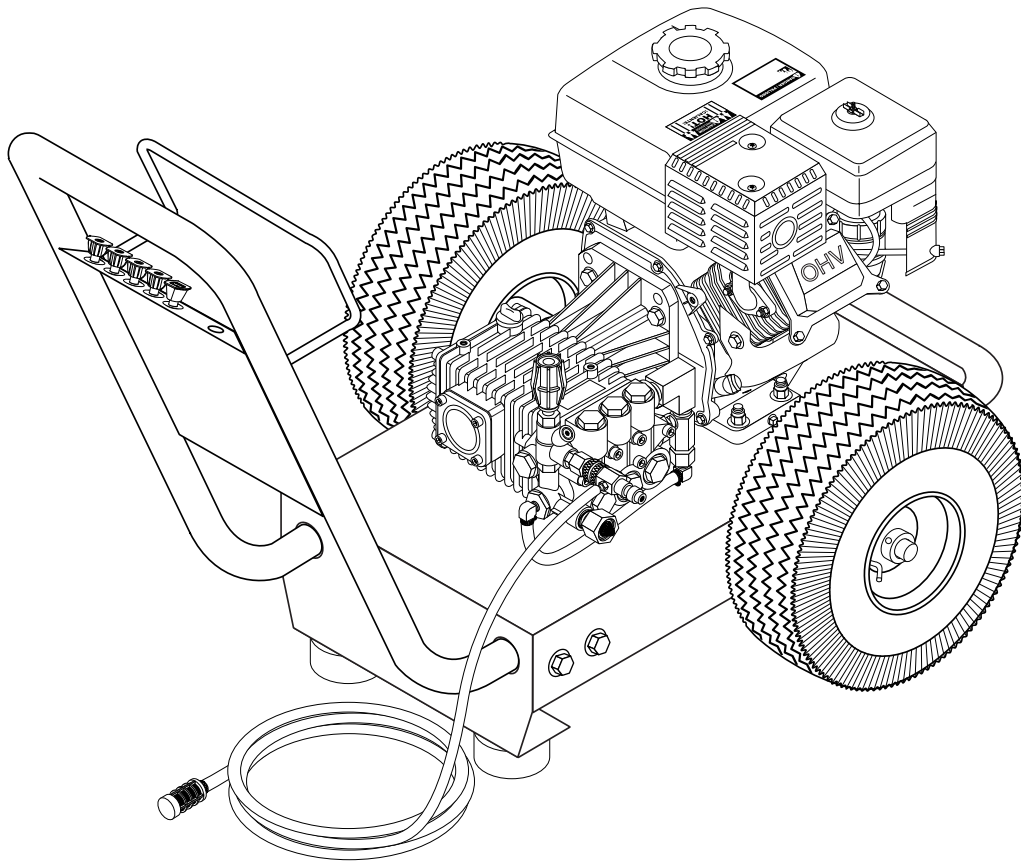

SHARK PRESSURE WASHERS ■ 4275 N.W. Pacific Rim Blvd. ■ Camas, WA 98607 ■ USA

For technical assistance or the Shark Dealer nearest you, call 1-800-771-1881.

MACHINE SPECIFICATIONS

● Pump Volume At Pump Head:

DG-3022	2.7 GPM
DG-3025	2.8 GPM
DG-3030	3.0 GPM
DG-3530	3.5 GPM
DG-3535	3.5 GPM
DG-4040	4.0 GPM

● Pump Pressure At Pump Head:

DG-3022	2200 PSI
DG-3025	2500 PSI
DG-3030	3000 PSI
DG-3530	3000 PSI
DG-3535	3500 PSI
DG-4040	4000 PSI

● Machine Dimensions:

DG-3022	Length = 32.5"	Width = 19.5"	Height = 23.5"
DG-3025	Length = 32.5"	Width = 19.5"	Height = 23.5"
DG-3030	Length = 32.5"	Width = 19.5"	Height = 23.5"
DG-3530	Length = 32.5"	Width = 19.5"	Height = 23.5"
DG-3535	Length = 32.5"	Width = 19.5"	Height = 23.5"
DG-4040	Length = 32.5"	Width = 19.5"	Height = 23.5"

CONTENTS

Introduction	4	Exploded View	9
Important Safety Information	4-5	Exploded View, Parts List	10-11
Pre-Operation Check	5	Hose & Spray Gun Assembly & Parts List	12
Set-Up Procedures	5	Troubleshooting	13-14
Component Identification	6	Preventative Maintenance	15
Operating Instructions	7	Oil Change Record	15
Shut Down Procedures	7	Storage	16
General Washing Techniques	7	Warranty	
How To Use the Detergent Injector	8		

SERIAL NUMBER:
DATE PURCHASED:
FOR SALES AND SERVICE, PLEASE CONTACT:

INTRODUCTION

Thank you for purchasing a Shark Pressure Washer.

This manual covers the operation and maintenance of the DG-302231, DG-302531, DG-303031, DG-353031, DG-353531, DG-404021, DG-302237, DG-302537, DG-303037, DG-353037, DG-353537, and DG-404027 washers. All information in this manual is based on the latest product information available at the time of printing.

Shark reserves the right to make changes at any time without incurring any obligation.

The DG Series was designed for maximum use of 4 hours per day, 5 days per week.

Owner/User Responsibility:

The owner and/or user must have an understanding of the manufacturer's operating instructions and warnings before using this Shark pressure washer. Warning information should be emphasized and understood. If the operator is not fluent in English, the manufacturer's instructions and warnings shall be read to and discussed with the operator in the operator's native language by the purchaser/owner, making sure that the operator comprehends its contents.

Owner and/or user must study and maintain for future reference the manufacturers' instructions.

This manual should be considered a permanent part of the machine and should remain with it if machine is resold.

When ordering parts, please specify model and serial number.

IMPORTANT SAFETY INFORMATION

CAUTION



CAUTION: To reduce the risk of injury, read operating instructions carefully before using.

1. Read the owner's manual thoroughly. Failure to follow instructions could cause malfunction of the machine and result in death, serious bodily injury and/or property damage.
2. All installations must comply with local codes. Contact your electrician, plumber, utility company or the selling distributor for specific details.



WARNING: Risk of asphyxiation — Use this product only in a well ventilated area.

3. Avoid installing machines in small areas or near exhaust fans. Exhaust contains poisonous carbon monoxide gas; exposure may cause loss of consciousness and may lead to

death. It also contains detergents known, in certain quantities, to cause cancer, birth defects, or other reproductive harm.



WARNING: Flammable liquids can create fumes which can ignite causing property damage or severe injury.

WARNING: Risk of fire — Do not add fuel when the product is operating.

WARNING: Risk of explosion — Do not spray flammable liquids.

4. Do not place machine near flammable objects as the engine is hot.
5. Allow engine to cool for 2 minutes before refueling. If any fuel is spilled, make sure the area is dry before testing the spark plug or starting the engine. (Fire and/or explosion may occur if this is not done.)
Gasoline engines on mobile or portable equipment shall be refuelled:
 - (a) outdoors;
 - (b) with the engine on the equipment stopped;
 - (c) with no source of ignition within 10 feet of the dispensing point; and
 - (d) with an allowance made for expansion of the fuel should the equipment be exposed to a higher ambient temperature.

In an overfilling situation, additional precautions are necessary to ensure that the situation is handled in a safe manner.



WARNING: High pressure stream of water that this equipment can produce can pierce skin and its underlying tissues, leading to serious injury and possible amputation.



WARNING: High pressure spray can cause paint chips or other particles to become airborne and fly at high speeds.

6. Eye safety devices and foot protection must be worn when using this equipment.
7. High pressure developed by these machines will cause personal injury or equipment damage. Use caution when operating. Do not direct discharge stream at people or severe injury or death will result.
8. Never make adjustments on machine while it is in operation.
9. Do not operate with spray gun in the off position for extensive periods of time as this may cause damage to the pump.
10. The best insurance against an accident is precaution and knowledge of the machine.
11. Shark will not be liable for any changes made to our standard machines, or any components not purchased from Shark.
12. Read engine safety instructions provided.



WARNING: Keep water spray away from electrical wiring or fatal electric shock may result.

13. Never run pump dry or leave spray gun closed longer than 2 minutes.
14. Do not allow children to operate the pressure washer at any time.
15. Inlet water supply must be cold and clean fresh water.

PRE-OPERATION CHECK

- ☐ Pump oil (SAE 30W non-detergent oil)
- ☐ Cold, clean, fresh water supply (6 GPM • 5/8" • 20 PSI)
- ☐ Hose, wand, nozzle (nozzle size per serial plate)
- ☐ Water filter (intact, non-restrictive)
- ☐ Fuel (unleaded 86 or higher octane)
- ☐ Engine oil (SAE 10W40)

SET-UP PROCEDURES

1. Attach a 5/8" garden hose to inlet connector. Minimum flow should be 6 GPM.

2. Attach high pressure hose to discharge nipple using quick coupler. Lock coupler securely into place by pulling back coupler collar and inserting it onto discharge nipple, then pushing collar forward to lock in place.

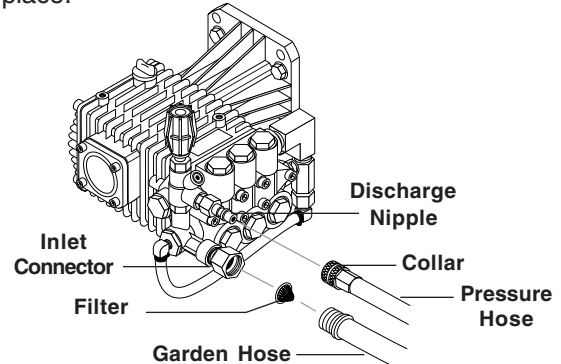

3. Attach wand to spray gun using teflon tape on threads to prevent leakage.
4. Attach swivel connector on discharge hose to spray gun using teflon tape on threads.
5. Remove oil plug on top of pressure washer pump and replace with dipstick supplied on vented cap on Comet pumps.

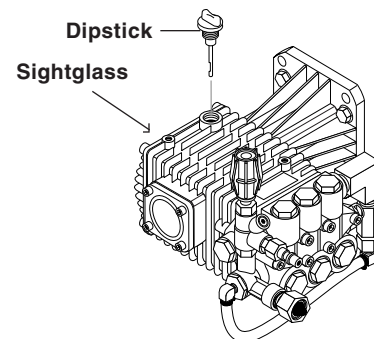

6. Check oil level on sight glass on side of pump. Oil should be visible one half way up sight glass (30W non-detergent).
7. Fill gasoline tank and check engine oil.

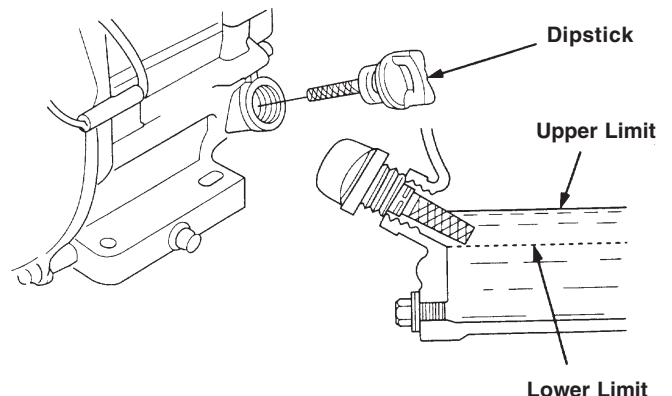

Notice: Running the engine with a low oil level can cause engine damage.

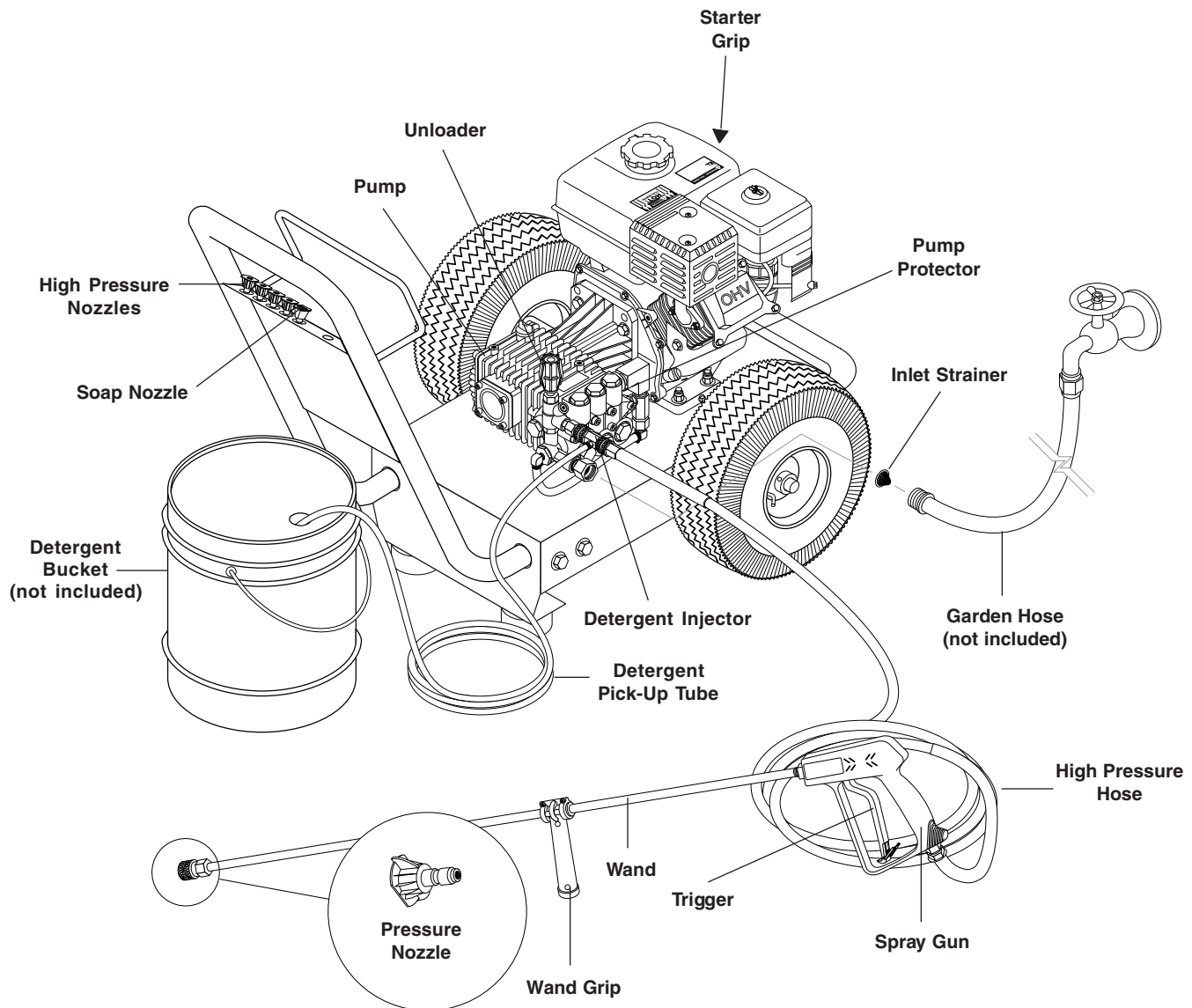
COMPONENT IDENTIFICATION
ALL MODELS

Pump — Develops high pressure.

Starter Grip — Used for starting the engine manually.

Spray Gun — Controls the application of water and detergent onto cleaning surface with trigger device. Includes safety latch.

Detergent Injector — Allows you to siphon and mix detergents.

Straight Through Wand w/Grip — Must be connected to the spray gun.

High Pressure Hose — Connect one end to water pump discharge nipple and the other end to spray gun.

Pump Protector — Cycles fresh cool water through pump when recirculating water reaches 140°F.

NOTE: *If trigger on spray gun is released for more than 2 minutes, water will leak from valve. Warm water will discharge from pump protector onto floor. This system prevents internal pump damage.*

OPERATING INSTRUCTIONS

1. Read engine warning and operating instructions.

2. Pull wand coupler collar back and insert pressure nozzle into coupler then secure by pushing collar forward to lock.

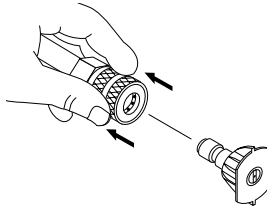

3. Turn on water at faucet and squeeze spray gun trigger allowing water to flow until a steady stream comes out of wand.

4. Move the fuel valve lever to the ON position. Turn the fuel valve lever to the OFF position after stopping engine.

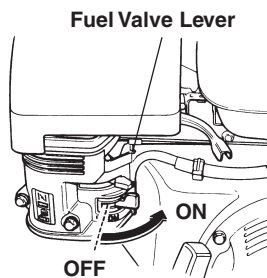

5. To start a cold engine, move the choke lever to the CLOSED position. To restart a warm engine, leave the choke lever in the OPEN position.

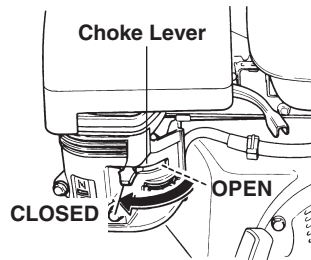

6. Turn the engine switch to the ON position.

7. Open spray gun before pulling the starter grip.

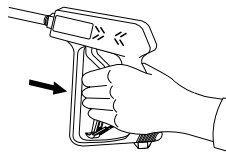

8. To start the engine pull the starter grip lightly until you feel resistance, then pull briskly. Return the starter grip gently.

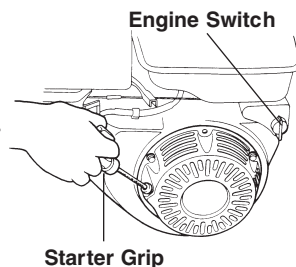

CAUTION: Pull trigger on spray gun to relieve pressure if machine does not start after one pull of the starter grip.

CAUTION: Small engines may kick back. Do not hold pull rope tightly in hand.

9. With the spray nozzle pointed away from you or anyone else, press the trigger on the spray gun to obtain pressurized spray.

SHUTDOWN PROCEDURES

1. If a detergent injector was used, flush all lines with clean water to remove soap residue.
2. Turn off engine. Turn off water supply.
3. Squeeze spray gun trigger to relieve any pressure.
4. Disconnect water supply hose from washer.

CAUTION: Do not allow pump to run without water.

5. Disconnect all hoses to allow water to drain. Protect from freezing.

CAUTION: Do not allow pump to run longer than 3 minutes without water. Disconnect all hoses to allow water to drain.

CAUTION: With machine off, open spray gun to release pressure before removing discharge hose.

GENERAL WASHING TECHNIQUES

Test pressure and spray pattern on hard surface (i.e. cement) to gauge distance and impact of water spray.

Hold spray nozzle approximately one foot from surface being cleaned. For best surface cleaning action, spray at a slight angle.

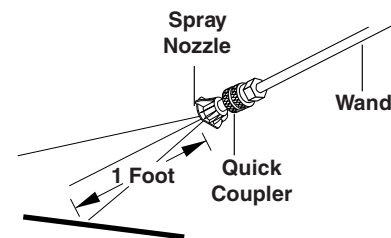

To change spray nozzle for a different pattern it is recommended that you turn off engine and squeeze spray gun trigger to release hose pressure. Pull back on quick coupler at end of wand and exchange nozzle. Make sure nozzle is seated securely. Restart engine.

Use the detergent injector to apply detergent. Wash from the bottom and work up. Allow detergent to set 5-10 min. on surface. Rinse from top down.

NOTE: If pressure washer is running and not being used for more than 2 minutes, turn off engine.

HOW TO USE THE DETERGENT INJECTOR



WARNING: Some detergents may be harmful if inhaled or ingested, causing severe nausea, fainting or poisoning. The harmful elements may cause property damage or severe injury.

The machine can siphon and mix detergents with the use of Shark's detergent injector kit.

1. Pull injector quick coupler collar back and secure on discharge nipple. Injector valve body arrow should point in direction of flow.
2. Connect pressure discharge hose to injector nipple securing quick coupler.

3. Start machine as outlined in Operating Instructions.
4. Place detergent pick-up tube into container of detergent solution.
5. Install the brass soap nozzle provided with the injector into the quick coupler of the wand.
6. Open spray gun. Water detergent ratio is approximately 15 to 1.
7. When you finish washing, rinse by simply releasing the trigger on the spray gun, removing the soap nozzle, and replacing the pressure nozzle back into quick coupler.

NOTE: The detergent injector will not siphon with the high pressure nozzle at the end of the wand.

8. For clean up, place detergent pick-up tube into container of clear water and follow steps 5 and 6 to prevent detergent deposits from damaging the injector.

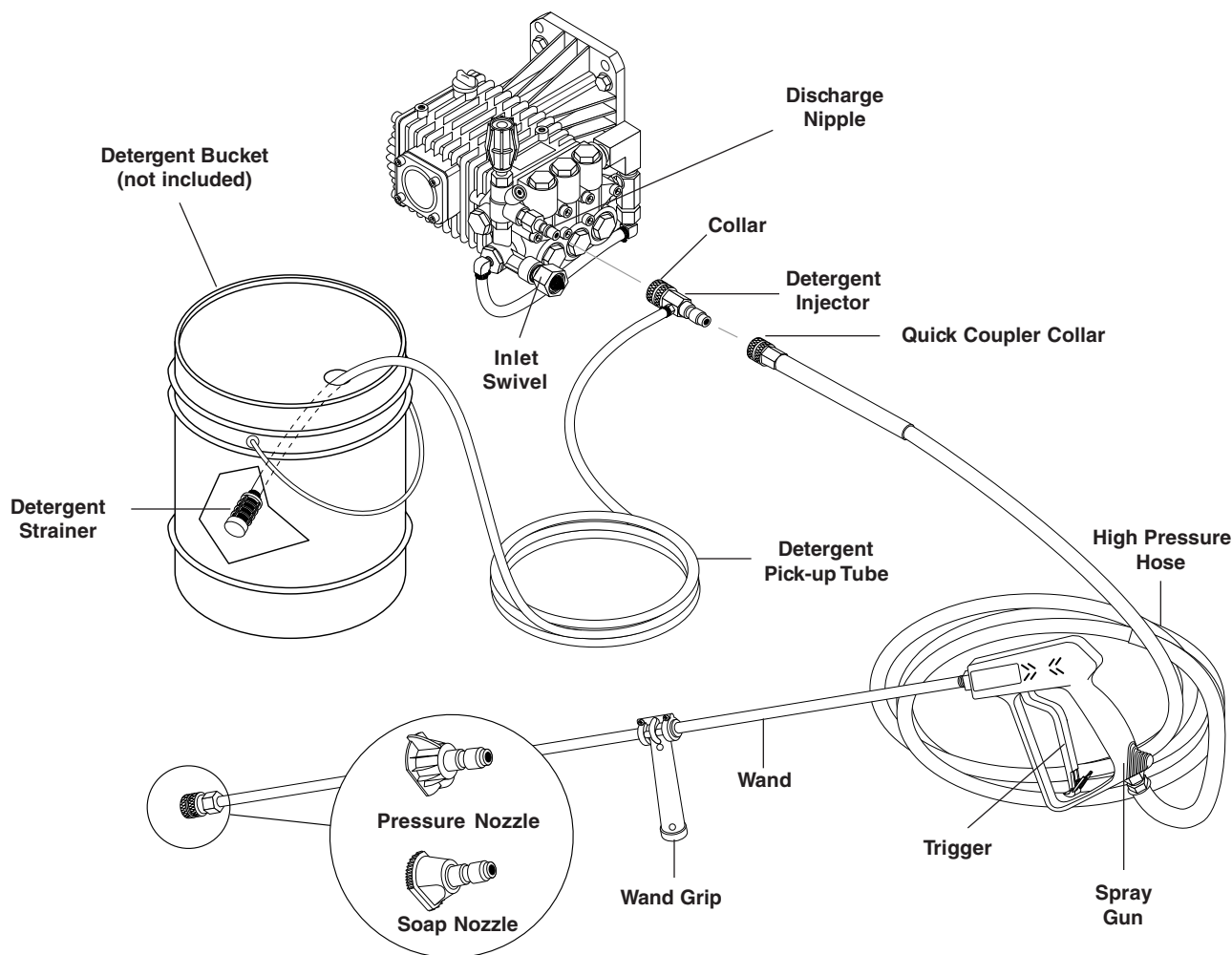

EXPLODED VIEW

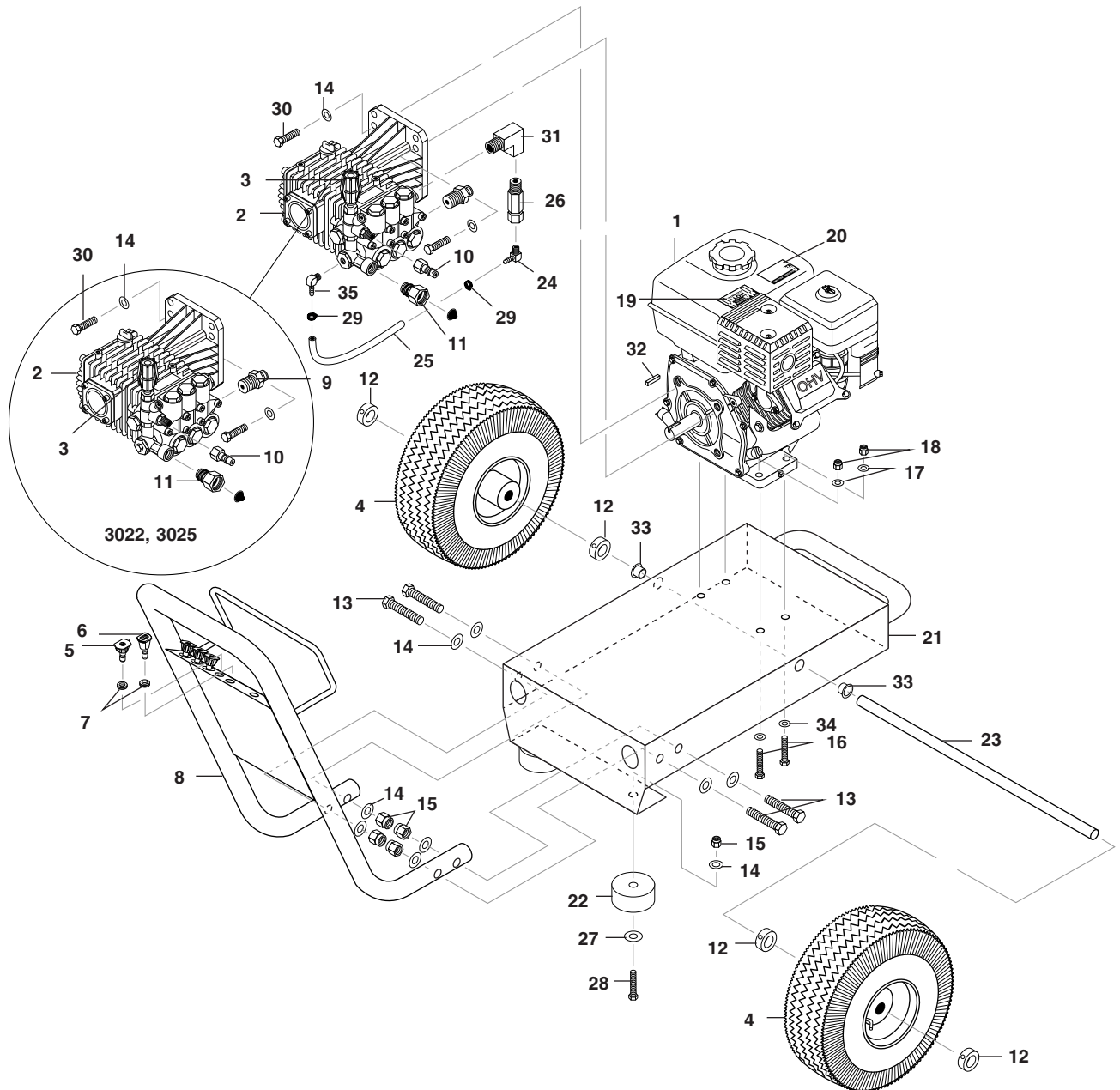

EXPLODED VIEW PARTS LIST

ITEM	PART NO.	DESCRIPTION	QTY
1	5-0104	Engine, Honda, GX160K1QX2, 5.5 HP (3022)	1
	5-01041	Engine, Honda, GX200K1QX2 6.5 HP (3025)	1
	5-0102	Engine, Honda, GX270QA2 9 HP (3030)	1
	5-0105	Engine, Honda, GX340KQAP2 11 HP (3530)	1
	5-010721	Engine, Honda, GX390K1QA2, 13 HP (3535)	1
	5-0306	Engine, Vanguard, 16 HP Pull/Start (4040)	1
	95-07101149	▲ Guard, Muffler, 16 HP Vanguard (4040)	1
	76-807964	▲ Muffler, Exhaust, 16 HP Vanguard (4040)	1
	95-07101214	▲ Heat Deflector, 16 HP Vanguard (4040)	1
	90-805849	▲ Screw, Hex, 1/4"-20 x 1/2" (4040)	4
	90-19711	▲ Screw, 1/4" x 1/2" HH, NC, Whiz Loc (4040)	4
	90-20231	Nut, Cage, 1/4" x 12 Ga. (4040)	4
	95-071011491	▲ Brace, Vanguard Muff Bracket (4040)	2
2	5-23027	Pump, General TP2530 (302231, 302531)	1
	5-2318	Pump, General, EZ-3035G (303031)	1
	5-2313	Pump, General, EZ-3040G (353031)	1
	5-2317	Pump, General, EZ-4040G (404021)	1
	5-23161	Pump, General, EZ-4035G34, 3.5 GPM @ 4000 PSI (353531)	1
	5-1630	Pump, Legacy WMG 2625 (302237)	1
	5-1631	Pump, Legacy WMG 2530 (302537)	1
	5-1635	Pump, Legacy WMG 3030 (303037)	1
	5-1640	Pump, Legacy TMG 3535 (353037)	1
	5-1643	Pump, Legacy TMG 4040 (353537, 404027)	1

ITEM	PART NO.	DESCRIPTION	QTY
3	5-3024	Unloader, General, Direct (302231, 302531)	1
	5-3022	Unloader, PA VB 75L (303031, 353031, 353531)	1
	5-3028	Unloader, PA 8 GPM @4000 PSI (404021)	1
	5-3151	Unloader, APR 3000 (302237, 302537, 303037, 353037)	1
	5-3152	Unloader, APR 35 (353537, 404027)	1
4	4-0303	Wheel & Tire Assy, 4" w/Tube	2
5	4-12803500	Nozzle, SACQMEG, 0003.5 Red (3022, 3025, 3030, 3535)	1
	4-12803515	Nozzle, SACQMEG, 1503.5 Yellow (3022, 3025, 3030, 3535)	1
	4-12803525	Nozzle, SACQMEG, 2503.5 Green (3022, 3025, 3030, 3535)	1
	4-12803540	Nozzle, SACQMEG 4003.5 White (3022, 3025, 3030, 3535)	1
	4-12804000	Nozzle, SACQMEG, 0004 Red (3530, 4040)	1
	4-12804015	Nozzle, SACQMEG, 1504 Yellow (3530, 4040)	1
	4-12804025	Nozzle, SACQMEG, 2504 Green (3530, 4040)	1
	4-12804040	Nozzle, SACQMEG 4004 White (3530, 4040)	1
6	4-16540	Nozzle Compl, QCEM-6540, Brass (Soap)	1
7	2-0103	Grommet, Rubber, Nozzle Holder	5
8	95-07200021	Handle, Assy, Grab	1
	11-0309	▲ Label, Nozzle, Warning, Opts	1
9	2-300816	Pump Protector, 3/8" PTP (302231, 302531)	1
	2-30082	Pump Protector, 1/2" PTP (302237, 302537, 3030, 3530, 3535, 4040)	1
10	2-2006	Nipple, 3/8" x 3/8" NPT ST FEM (302231, 302237, 302531, 302537, 303037, 353037, 353537)	1

EXPLODED VIEW PARTS LIST (CON'T)

ITEM	PART NO.	DESCRIPTION	QTY
10	2-2007	Nipple, 3/8" x 3/8" NPT ST FEM (303031, 353031, 353531)	1
	2-20022	Nipple, 3/8" Female, 5000 PSI (4040)	1
	2-0006	▲ Nipple, 3/8" Hex Steel (4040)	1
11	2-10942	Swivel, 1/2" MP x 3/4" GHF w/Strainer (302237, 302537, 3030, 3530, 3535, 4040)	1
	2-10943	Swivel, 3/8" MP x 3/4" GHF, w/Strainer (302231, 302531, 303031, 353031, 353531, 404031)	1
12	90-20041	Collar, 5/8" Bore Shaft	4
13	90-1020	Bolt, 3/8" x 2", NC, HH	4
14	90-4002	Washer, 3/8", Flat (3022, 3025 Qty 10; 3030, 3530, 3535, 4040 Qty. 14)	
	90-4001	Washer, 3/8", Flat (3022, 3025)	4
15	90-2002	Nut, 3/8" ESNA, NC (3030, 3530, 3535 Qty. 10; 3022, 3025 Qty. 6; 4040 Qty 6)	
16	90-1009	Bolt, 5/16" x 1-1/2" (3022, 3025)	4
	90-1019	Bolt, 3/8" x 1-3/4" (3030, 3530, 3535)	4
	90-1010	Bolt, 5/16" x 1-3/4" (4040)	4
17	90-4001	Washer, 5/16" Flat (3022, 3025, 4040)	8
	90-4002	Washer, 3/8" Flat (3030, 3530, 3535)	8
18	90-2001	Nut, 5/16" ESNA, NC (3022, 3025, 4040)	4
	90-2002	Nut, 3/8" ESNA (3530, 3535, 3030)	4
19	10-02025A	Label, "Hot/Caliente" w/Arrows Warning	1

ITEM	PART NO.	DESCRIPTION	QTY
20	10-02029	Label, Danger Cool Engine	1
21	95-0720025	Frame, Assy	1
22	2-01041	Pad, Soft Rubber, 50 Duro	2
23	95-07101136	Axle, 5/8" x 18" Long	1
24	2-1088	Barb, Hose, Elbow 90° 1/4" x 1/8" (General Pump, 3030, 3530, 3535, 4040)	2
25	4-02100000	Hose, 1/4" Push-on /in. (3030, 3530, 3535, 4040)	10
26	2-3100544	Valve, EZ Start (3030, 3530, 3535, 4040)	1
27	90-40125	Washer, 3/8" x 1", Steel	2
28	90-1017	Bolt, 3/8" x 1-1/4"	2
29	2-9000	Clamp, Hose, #4 (3030, 3530, 3535, 4040)	2
30	90-1017	Bolt, 3/8" x 1-1/4" (3030, 3530, 3535, 4040)	4
	90-10074	Bolt (3022, 3025)	4
31	2-0031	Elbow, 3/8" Street (3030, 3530, 3535, 4040)	1
32	95-07141120	Key, 0.185 SQR x 1.75"	1
	95-07141121	Key, 0.247 SQR x 2.125 (3030, 3530, 3535, 4040)	1
33	2-01403	Bushing, Snap, 5/8"	2
34	90-4006	Washer, 5/16" x 1-1/4", Fender (3022, 3025)	1
35	2-1088	Barb, Elbow 90°, 1/4" x 1/8" General Pump (303031, 303531, 353531, 404021)	1
	2-1089	Hose Barb, 90°, 1/4" x 1/4" Legacy Pump (303037, 353037, 353537, 404027)	1
		▲ Not Shown	

HOSE & SPRAY GUN ASSEMBLY

ALL MODELS

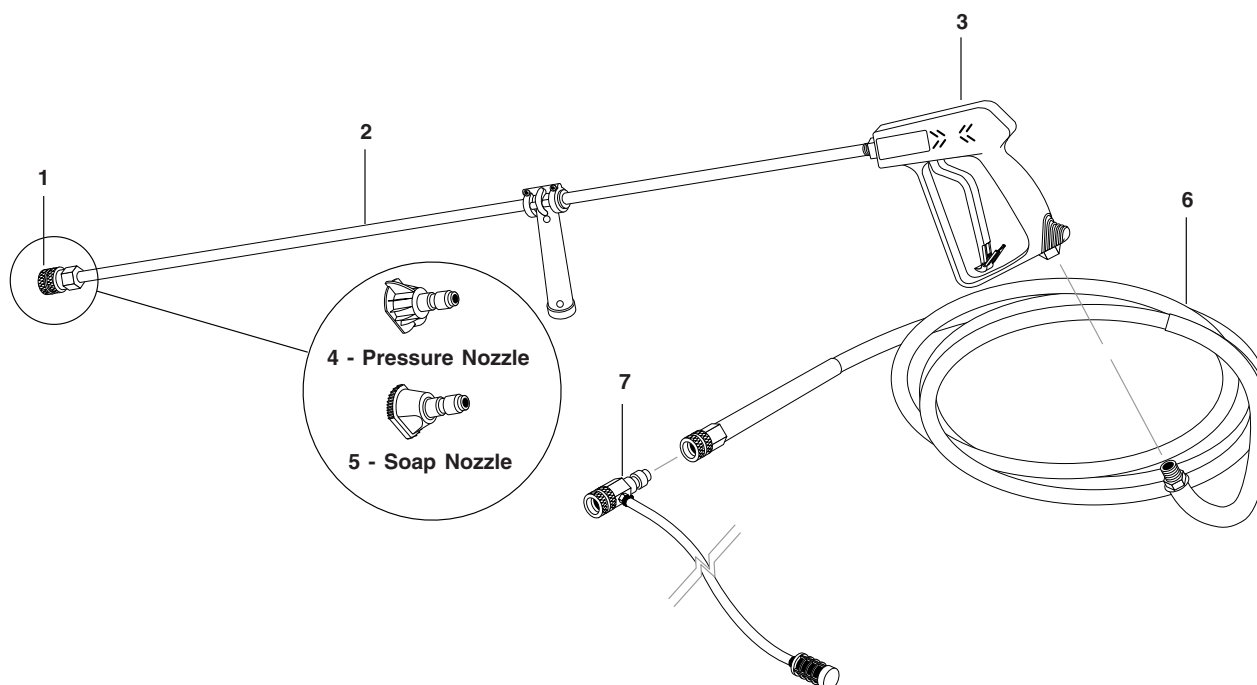

ITEM	PART NO.	DESCRIPTION	QTY
1	2-2000	Coupler, 1/4" Female, Brass	1
2	4-0110413	Wand, Assy, Side Grip with 1/4" Coupler, 31.4", 5000 PSI	1
3	4-01246	Spray Gun, Shut-off, AP-1000	1
4		High Pressure Nozzle (See Exploded View Parts List)	1
5	4-16540	Nozzle Compl, QCEM-6540, Brass	1
6	4-02093450BC	Hose, 3/8" x 50', 1 Wire, w/ Coupler (3022, 3025, 3030, 3530)	1

ITEM	PART NO.	DESCRIPTION	QTY
6	4-02073450RC	Hose, 3/8" x 50', 2 Wire, w/Coupler (3535)	1
	4-02083450F	Hose, 3/8" x 50', 2 Wire w/Coupler (4040)	1
7	4-011183	Detergent Injector Assy, 0.70" (3030, 3022, 3025)	1
	4-011184	Detergent Injector Assy, 0.83" (3530, 3535)	1
	4-011186	Detergent Injector Assy, 5000 PSI (4040)	1

▲ Not Shown

TROUBLESHOOTING

PROBLEM	POSSIBLE CAUSE	SOLUTION
LOW OPERATING PRESSURE	Insufficient water supply	Use larger supply hose; clean inlet water screen. Open faucet.
	Old, worn or incorrect spray nozzle	Match nozzle number to machine and/or replace with new nozzle.
	Plumbing or hose leak	Check plumbing system for leaks. Retape leaks with teflon tape.
	Faulty or misadjusted unloader valve	Adjust unloader for proper pressure. Install repair kit when needed. Call Shark technical support.
	Worn packing in pump	Call Shark technical support.
	Machine has been stored in freezing temperatures	Thaw out machine completely, including hose, spray gun and wand.
	Slow engine RPM	Call Shark technical support
FLUCTUATING PRESSURE	Worn pump valves	Call Shark technical support.
	Dirt in pump valves	Call Shark technical support.
	Pump sucking air	Check all pump lines and connections.
PRESSURE LOW AFTER PERIOD OF NORMAL USE	Nozzle worn	Replace nozzle.
	Unloader valve worn	Replace unloader valve.
ENGINE WILL NOT START OR STOPS WHILE OPERATING	Low oil shutdown	Fill engine with oil.
ENGINE IS OVERLOADED	Nozzle partially blocked	Clean nozzle.
	Excessive pressure from high engine RPM	Adjust engine throttle to lower RPM.
WATER OR OIL LEAKING FROM BOTTOM OF PUMP	A small amount of leaking is normal	If excessive leaking occurs, call Shark technical support.
PRESSURE INCREASES WHEN SPRAY GUN IS CLOSED	Unloader valve not operating properly	Call Shark technical service.
PRESENCE OF WATER IN PUMP OIL	Water sprayed at machine	Change oil. Direct spray away from machine.
	High humidity in air	Check and change oil twice as often.
	Piston packing worn. Oil seal worn	Call Shark technical support.

TROUBLESHOOTING

PROBLEM	POSSIBLE CAUSE	SOLUTION
OIL SQUIRTS OUT OF OIL CAP ON PUMP	Pump over filled with oil	Maintain oil level at red dot on sight glass at rear of pump or at top of notch on dipstick.
ENGINE OPERATES FOR 15 MIN. THEN STOPS	Not enough gas or engine oil	Fill tank with gas. Check oil level.
	Vapor lock developed by heat of day	Keep gas tank full to avoid vapor locking.
	Obstruction in fuel filter	Clean or replace fuel filter.
WATER DRIPPING FROM UNDER PUMP	Piston packing worn	Call Shark technical service.
	O-Ring plunger retainer worn	Call Shark technical service.
	Cracked piston	Call Shark technical service.
OIL DRIPPING	Oil seal worn	Call Shark technical service.
WATER LEAKING FROM PUMP PROTECTOR	Spray gun closed with machine running 2 minutes or longer	Open spray gun or turn off machine.
	Excess water supply pressure	Place a pressure regulator at end of 50' garden hose.

PREVENTATIVE MAINTENANCE

This pressure washer was produced with the best available materials and quality craftsmanship. However, you as the owner have certain responsibilities for the correct care of the equipment. Attention to regular preventative maintenance procedures will assist in preserving the performance of your equipment. Contact your Shark dealer for maintenance. Regular preventative maintenance will add many hours to the life of your pressure washer. Perform maintenance more often under severe conditions.

MAINTENANCE SCHEDULE		
Engine Oil	Inspect	Daily
	Change	First month or 20 hours. Every 100 hours or every 6 months after first month.
	Filter	Every 50 hours
Air Cleaner	Inspect	Every 50 hours
	Clean	Monthly
Engine Fuel Filter		500 hours or 6 months
Spark Plug Maintenance		300 hours or annually
Clean Fuel Tank(s)		Annually
Replace Fuel Lines		Annually
Pump Oil	Inspect	Oil level daily
	Change	After first 50 hours, then every 500 hours or annually
Replace High Pressure Nozzle		Every 6 months
Replace Quick Connectors		Annually
Clean Water Screen/Filter		Weekly
Replace HP Hose		Annually (if there are any signs of wear)

OIL CHANGE RECORD

Check pump oil and engine oil level before first use of your new pressure washer.

Date Oil Changed Month/Day/Year	Estimated Operating Hours Since Last Oil Change

Date Oil Changed Month/Day/Year	Estimated Operating Hours Since Last Oil Change

STORAGE

Pump Storage



CAUTION

CAUTION: Always store your pressure washer in a location where the temperature will not fall below 32°F (0° C). The pump in this machine is susceptible to permanent damage if frozen. **FREEZE DAMAGE IS NOT COVERED BY WARRANTY.**

If you must store your pressure washer in a location where the temperature is below 32°F, you can minimize the chance of damage to your machine by draining your machine as follows:

1. Stop the pressure washer and detach supply hose and high pressure hose. Squeeze the trigger of the spray gun to drain all water from the wand and hose.
2. Restart pressure washer and let it run briefly (about 5 seconds) until water no longer discharges from the high pressure outlet.

Engine Storage

When the pressure washer is not being operated or is being stored more than one month, follow these instructions:

1. Replenish engine oil to upper level.
2. Drain gasoline from fuel tank, fuel line, fuel valve and carburetor.
3. Pour about one teaspoon of engine oil through the spark plug hole, pull the starter grip several times and replace the plug. Then pull the starter grip slowly until you feel increased pressure which indicates the piston is on its compression stroke and leave it in that position. This closes both the intake and exhaust valves to prevent the inside of the cylinder from rusting.

4. Cover the pressure washer and store in a clean, dry place that is well ventilated away from open flame or sparks.

NOTE: The use of a fuel additive, such as STA-BIL®, or an equivalent, will minimize the formulation of fuel gum deposits during storage. Such an additive may be added to the gasoline in the fuel tank of the engine, or to the gasoline in a storage container.

After Extended Storage

CAUTION: Prior to restarting, thaw out any possible ice from pressure washer hoses, spray gun or wand.

Engine Maintenance



CAUTION

During the winter months, rare atmospheric conditions may develop which will cause an icing condition in the carburetor. If this develops, the engine may run rough, lose power and may stall.

This temporary condition can be overcome by deflecting some of the hot air from the engine over the carburetor area.

NOTE: Refer to the engine manufacturer's manual for service and maintenance of the engine.



DG SERIES PRESSURE WASHER WARRANTY

SHARK LIMITED NEW PRODUCT WARRANTY PRESSURE WASHERS

WHAT THIS WARRANTY COVERS

All SHARK PRESSURE WASHERS are warranted by SHARK to the original purchaser to be free from defects in materials and workmanship under normal use, for the periods specified below. This Limited Warranty is subject to the exclusions shown below, is calculated from the date of the original purchase, and applies to the original components only. Any parts replaced under this warranty will assume the remainder of the part's warranty period. This warranty applies to the original purchaser and is not transferable.

LIMITED LIFETIME PARTS WARRANTY:

Components manufactured by SHARK, such as frames, handles, coil wraps, float tanks, and belt guards. All heating coils will have a one year warranty. Internal components on the oil-end of all pressure washer pumps will have a seven year warranty.

ONE YEAR PARTS WARRANTY:

All other components, excluding normal wear items as described below, will be warranted for one year on parts. Warranty on these parts will be for one year regardless of the duration of the original component manufacturer's part warranty.

WARRANTY PROVIDED BY OTHER MANUFACTURERS:

Motors, generators, and engines, which are warranted by their respective manufacturers, are serviced through these manufacturers' local authorized service centers. SHARK cannot provide warranty on these items.

WHAT THIS WARRANTY DOES NOT COVER

This warranty does not cover the following items:

1. Normal wear items, such as nozzles, guns, discharge hoses, wands, quick couplers, seals, filters, gaskets, O-rings, packings, pistons, pump valve assemblies, strainers, belts, brushes, rupture disks, fuses, pump protectors.
2. Damage or malfunctions resulting from accidents, abuse, modifications, alterations, incorrect installation, improper servicing, failure to follow manufacturer's maintenance instructions, or use of the equipment beyond its stated usage specifications as contained in the operator's manual.
3. Damage due to freezing, chemical deterioration, scale buildup, rust, corrosion, or thermal expansion.
4. Damage to components from fluctuations in electrical or water supply.
5. Normal maintenance service, including adjustments, fuel system cleaning, and clearing of obstructions.
6. Transportation to service center, shop labor charges, field labor charges, or freight damage.

WHAT YOU MUST DO TO OBTAIN WARRANTY SERVICE

While not required for warranty service, we request that you register your SHARK pressure washer by returning the completed registration card. In order to obtain warranty service on items, you must return the product to an Authorized SHARK Dealer, freight prepaid, with proof of purchase, within the applicable warranty period. If the product is permanently installed, you must notify your Authorized SHARK Dealer of the defect. The Authorized Dealer will file a claim, which must subsequently verify the defect. In most cases, the part must be returned to SHARK freight prepaid with the claim. For warranty service on components warranted by other manufacturers, the Authorized Dealer can help you obtain warranty service through these manufacturers' local authorized service centers. If you are unable to resolve the warranty claim satisfactorily, write to SHARK at 4275 N.W. Pacific Rim Blvd., Camas, WA 98607, ATTN: Warranty Dept., detailing the nature of the defect, the name of the Authorized Dealer, and a copy of the purchase invoice.

LIMITATION OF LIABILITY

SHARK'S liability for special, incidental, or consequential damages is expressly disclaimed. In no event shall SHARK'S liability exceed the purchase price of the product in question. SHARK makes every effort to ensure that all illustrations and specifications are correct, however, these do not imply a warranty that the product is merchantable or fit for a particular purpose, or that the product will actually conform to the illustrations and specifications. **THE WARRANTY CONTAINED HEREIN IS IN LIEU OF ALL OTHER WARRANTIES, EXPRESS OR IMPLIED, INCLUDING ANY IMPLIED WARRANTY OF FITNESS FOR A PARTICULAR PURPOSE.** SHARK does not authorize any other party, including authorized Dealers, to make any representation or promise on behalf of SHARK, or to modify the terms, conditions, or limitations in any way. It is the buyer's responsibility to ensure that the installation and use of SHARK products conforms to local codes. While SHARK attempts to assure that its products meet national codes, it cannot be responsible for how the customer chooses to use or install the product.

SHARK PRESSURE WASHERS

4275 N.W. Pacific Rim Blvd. • Camas, WA 98607 • USA • 1-800-771-1881



4275 N.W. Pacific Rim Blvd. • Camas, WA 98607 • 1-800-771-1881
Form #97-6124 • Revised 8/02 • Printed in U.S.A.